

NOTE: Indicative site for de-watering works (by others - LBH). Silt will be stored in approximate location in 800m2 banded lagoon to de-water, works ahead of contract. Once dried silt to be utilised within the works - proposed earth bunds - ensuring the silt is capped within the mounds as formed.

Exact setting out of trackway to be agreed on-site with CA prior to commencement, (contractor to mark out route for approval)

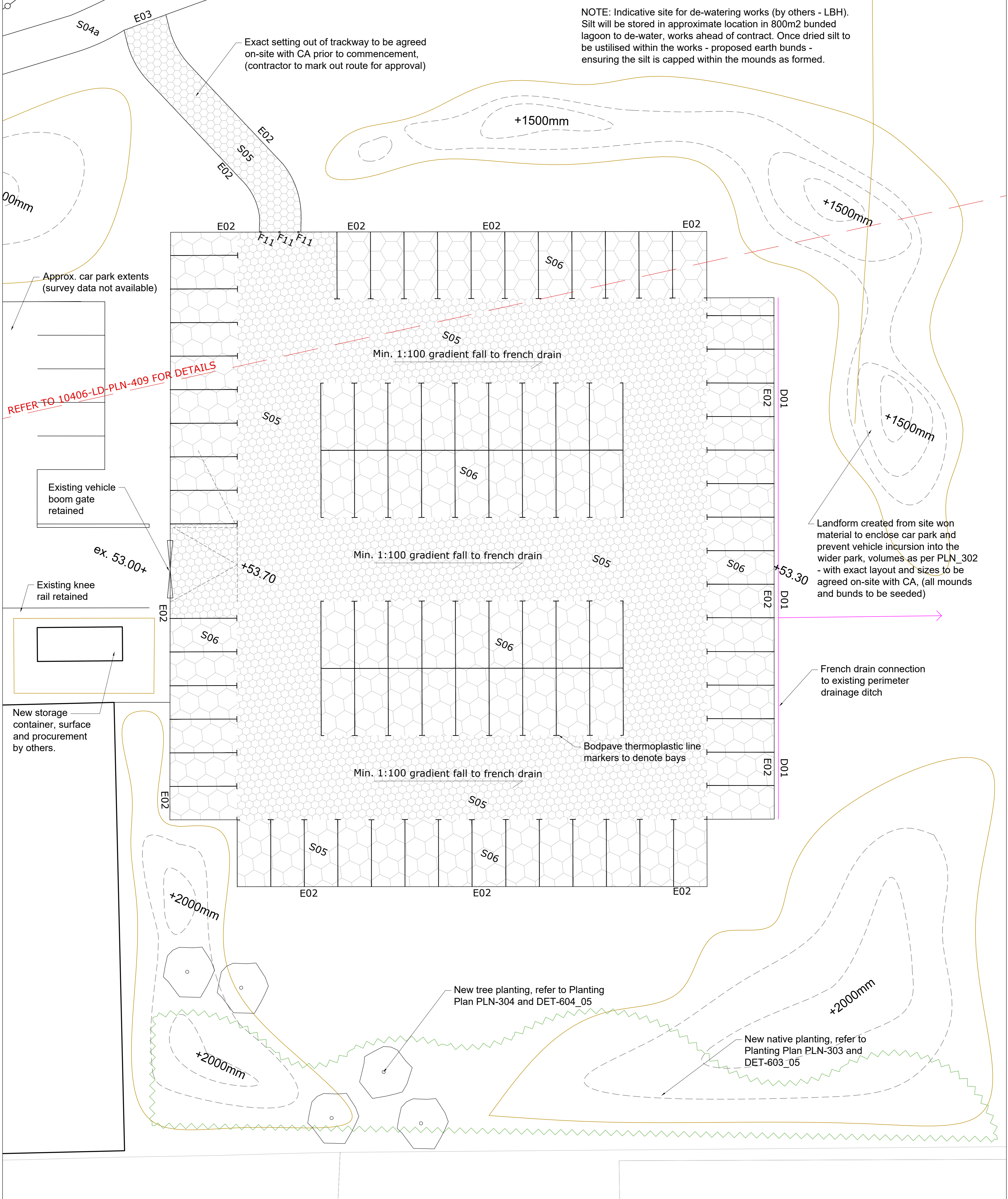

Approx. car park extents (survey data not available)

REFER TO 10406-LD-PLN-409 FOR DETAILS

Existing vehicle boom gate retained

ex. 53.00+

Existing knee rail retained

New storage container, surface and procurement by others.

Landform created from site won material to enclose car park and prevent vehicle incursion into the wider park, volumes as per PLN_302 - with exact layout and sizes to be agreed on-site with CA, (all mounds and bunds to be seeded)

French drain connection to existing perimeter drainage ditch

New tree planting, refer to Planting Plan PLN-304 and DET-604_05

New native planting, refer to Planting Plan PLN-303 and DET-603_05

Notes:
 1. Do not scale from this drawing.
 2. All dimensions must be checked on site and any discrepancies verified with landscape architect.
 3. All dimensions are drawn in mm.
 4. Landscape drawing only.
 5. All materials/items used to be as specified or alternatives to be approved by landscape architect.

Sheet Notes:
 Please read the adjacent plan in conjunction with the below:
 10406-LD-PLN-200 Tree and Vegetation Clearance
 10406-LD-PLN-201 Demolition and Site Clearance
 10406-LD-PLN-301-S Site Wide Plans

- Making Good: the contractor is to make allowance to ensure all edges and joins with adjacent surfaces are made good, married into to existing levels, and with the appropriate surface/edging material, (e.g. timber edging to marry into existing edge type).

- General Items: Please refer to ALL necessary landscape construction details as indicated and required. Where not referenced, the contractor is responsible for the identification of relevant details (and specification clauses) to ALL work items across the site, and/or to notify the CA prior to commencement on-site.

Relocation/new proposed setting out: this is to be agreed on-site with the CA prior to commencement of works, unless stated otherwise. Allowance is to be made for ALL relocated items to have new footings/surface pads installed under CA direction.

Contractor is responsible for ALL necessary protection of existing trees and vegetation to be retained, (in line with BS: 5837:2012). Full Arboricultural Impact Assessment and details of tree protection can be found in 1057-02/1 - 5 by SJ Stephens.

All construction works are to be carried out in accordance with the latest statutory guidance, building regulations and national building specification standards. N.B. SM consent to be observed.

Contractor is to follow standard practices and provide method/access statements for the excavation of all watercourse items in accordance with the Engineers' drawings and details.

The contractor is to make allowance for appropriate surveying (e.g. CAT scan etc.) to areas where break out is required - in accordance with HSE regulations. Where existing services are discovered and not previously surveyed, the contractor is to down tools and notify the client and CA for further instruction.

- KEY:**
- Site boundary
 - Existing tree planting
 - Existing levels
 - Proposed levels
 - Existing manhole/gully

- SOFT LANDSCAPE**
- Native hedge planting
Refer to 10406-LD-PLN-303 for details
 - Earthworks + embankments
Site won material, graded typically to 1:3 unless otherwise noted on the drawing. Refer to 10406-LD-DET-601_S01 for more information.
- SURFACES**
- Self-binding gravel footpath-pedestrian
Cowwell gravel or similar. To pedestrian loading. Please refer to 10406-LD-DET-601_S01 for more information.
 - Reinforced plastic Bodpave 85 - HGV
Seeded amenity grass surfacing HGV build up. Please refer to 10406-LD-DET-601_S05 for more information.
 - Reinforced plastic Bodpave 85 - LGV
Seeded amenity grass surfacing LGV build up. Please refer to 10406-LD-DET-601_S06 for more information.
 - Proposed tarmac cycleway
Please refer to 10406-LD-DET-601_S04a for more information.
- EDGING**
- 19mm timber edging
Softwood pressure treated timber laid flush, 150x19mm. 50x50x500mm softwood pegs @ 0.5m centres / double peg corners. Please refer to 10406-LD-DET-601_E01 for more information.

- 38mm timber edging
Softwood pressure treated timber laid flush, 150x38mm. 50x50x500mm softwood pegs @ 0.5m centres / double peg corners. Please refer to 10406-LD-DET-601_E02 for more information.
 - Concrete conservation kerb
250mm Conservation kerb to marry in to Harrow View West edging. Please refer to 10406-LD-DET-602_E03 for more information.
 - Granite setts (single row)
100mmx100mmx100mm silver grey granite cubes. Please refer to 10406-LD-DET-602_E04 for more information.
 - French drain (w/100mm perforated pipe)
Linear channel (w/150mm topsoil + grass seed overlay) to east extents of overflow CP. Outflow connection to adjacent ditch. Please refer to 10406-LD-DET-602_D01 for more information.
- FURNITURE**
- Timber post and wire fence
3 strand wire and timber post fence, (to Hoat perimeter). Refer to 10406-LD-DET-606
 - Drop down bollard (to overflow CP)
Colour black (powder coated). Drop-down Swinmax Steel Bollard BX14 6531-RM (1000mm high). Root fixed, to manufacturer's detail
 - Wayfinding / trail posts
Timber posts with retro graphic panel, to be located in soft adjacent to existing/prop path network, with exact locations to be agreed on-site with CA. Supplier: Fitzpatrick Woolmer. Refer to 10406-LD-DET-605

B	13/03/19	Record Issue	LR	AM	AVP
A	07/02/19	Issue	LR	AM	AVP
Rev	Date	Issue Notes	LR	AM	AVP

LUC 43 Chalton Street
London, NW1 1JD
T: 020 7383 5784
F: 020 7383 4798
london@landuse.co.uk
www.landuse.co.uk

Project: Headstone Manor Park
Client: London Borough of Harrow
Title: Detail Area: Overflow Car Park
Scale: 1:125 @ A1
Status: Tender

Job No. 10406 Drawing No. 10406-LD-PLN-405 Issue B

Do not scale from this drawing
© Drawing & Design Copyright © LUC